

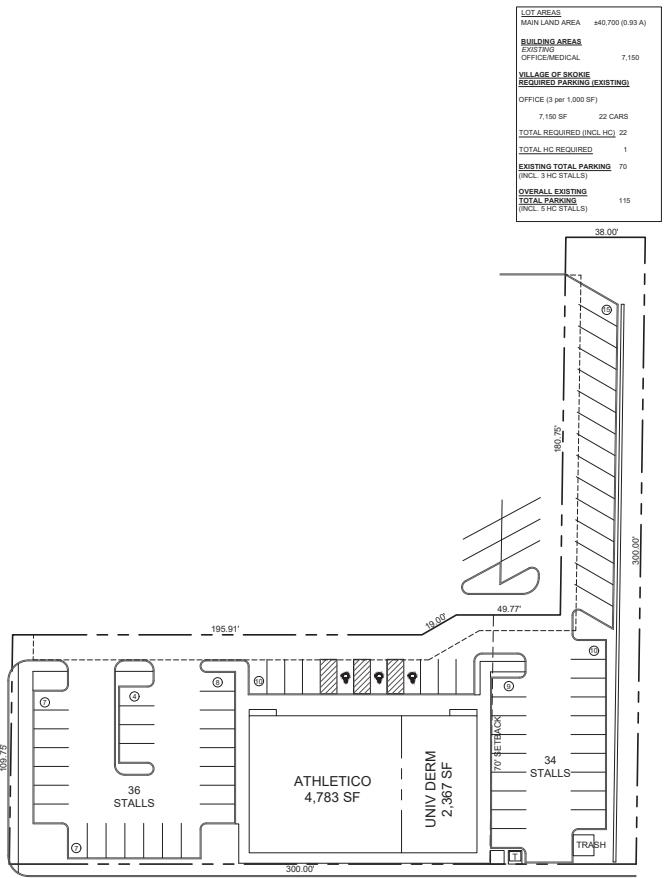

1 OVERALL EXISTING SITE PLAN
SCALE: NONE



1 EXISTING SITE PLAN
SCALE: 1" = 20'-0"

LOT AREAS	
MAIN LAND AREA	±40,700 (0.93 A)
BUILDING AREAS	
EXISTING OFFICE/MEDICAL	7,150
VILLAGE OF SNOKE REQUIRED PARKING (EXISTING)	
OFFICE (3 per 1,000 SF)	7,150 SF 22 CARS
TOTAL REQUIRED (INCL HC)	22
TOTAL HC REQUIRED	1
EXISTING TOTAL PARKING (INCL 3 HC STALLS)	70
OVERALL EXISTING TOTAL PARKING (INCL 3 HC STALLS)	115

UNIVERSITY DERMATOLOGY ADDITION/ INTERIOR ALTERATIONS	
ENC	16.28.2000
DATE	2019-10-12
AS NOTED	
AS1	

UNIVERSITY DERMATOLOGY ADDITION/ INTERIOR ALTERATIONS	
ENC	16.28.2000
DATE	2019-10-12
AS NOTED	
AS2	

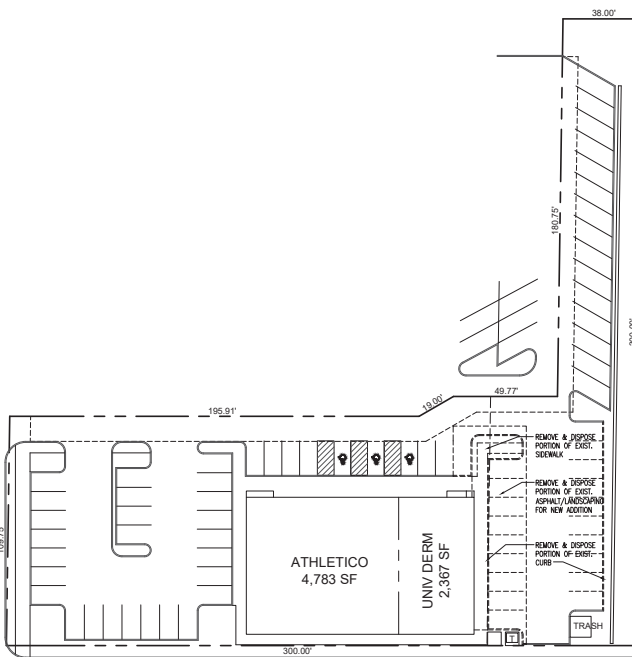

1 SITE PLAN - DEMOLITION
SCALE: 1" = 20'-0"

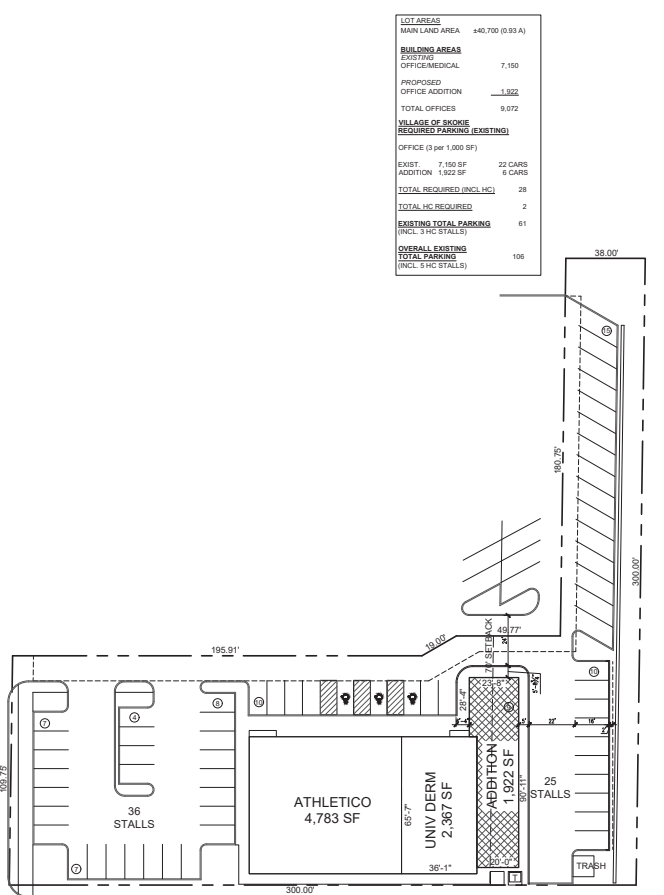

1 SITE PLAN - PROPOSED
SCALE: 1" = 20'-0"

LOT AREAS	
MAIN LAND AREA	±40,700 (0.93 A)
BUILDING AREAS	
EXISTING OFFICE/MEDICAL	7,150
PROPOSED OFFICE ADDITION	1,922
TOTAL OFFICES	9,072
VILLAGE OF SNOKE REQUIRED PARKING (EXISTING)	
OFFICE (3 per 1,000 SF)	9,072 SF 28 CARS
EXIST. 7,150 SF	22 CARS
ADDITION 1,922 SF	6 CARS
TOTAL REQUIRED (INCL HC)	28
TOTAL HC REQUIRED	2
EXISTING TOTAL PARKING (INCL 3 HC STALLS)	61
OVERALL EXISTING TOTAL PARKING (INCL 3 HC STALLS)	106

UNIVERSITY DERMATOLOGY ADDITION/ INTERIOR ALTERATIONS	
ENC	16.28.2000
DATE	2019-10-12
AS NOTED	
AS2	